

Technical Guide:

Applying a Lockout

Step 1: After unlocking your lock, select the detected lock to access the Lockout Info screens. On the Lock info page, select 'Apply'.

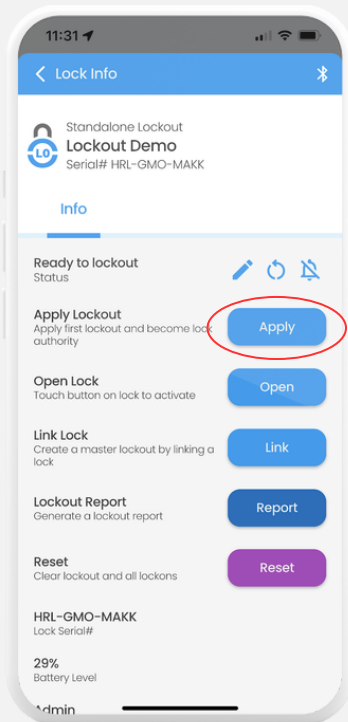

Step 2: On the Apply Lockout screen, complete the 'Prepare' checklist and if required, add a SmartTag.

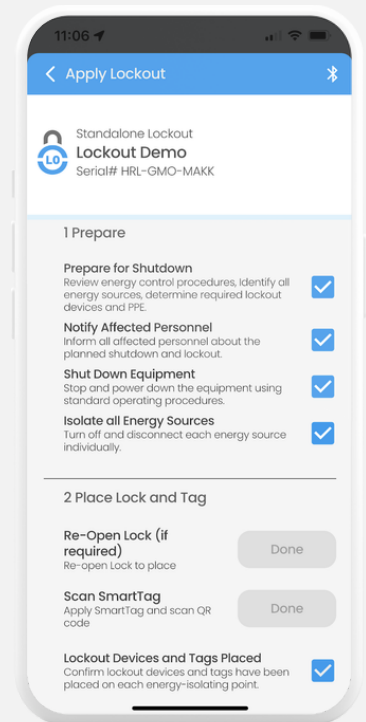

Step 3: If required, document photo evidence and add notes. Activate your Lock by touching the button on its base and selecting 'Apply'.

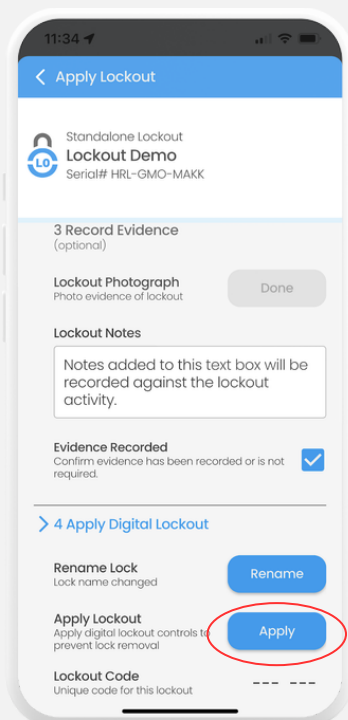

Step 4: The Apply Lockout screen will turn red, and a Lockout Code will appear, indicating that the lockout is active.

